

BALLI48S

Sink: BN1210SSINK

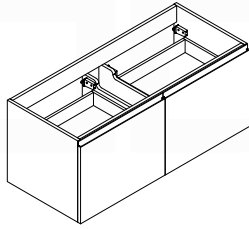

Dimensions:	width	depth	height
inches	47.6"	20.66"	21.06"
mm	1210	525	535

NOTE: DIMENSIONS AND TECHNICAL DETAILS ARE SUBJECT TO CHANGE WITHOUT NOTICE

. FRONT ELEVATION

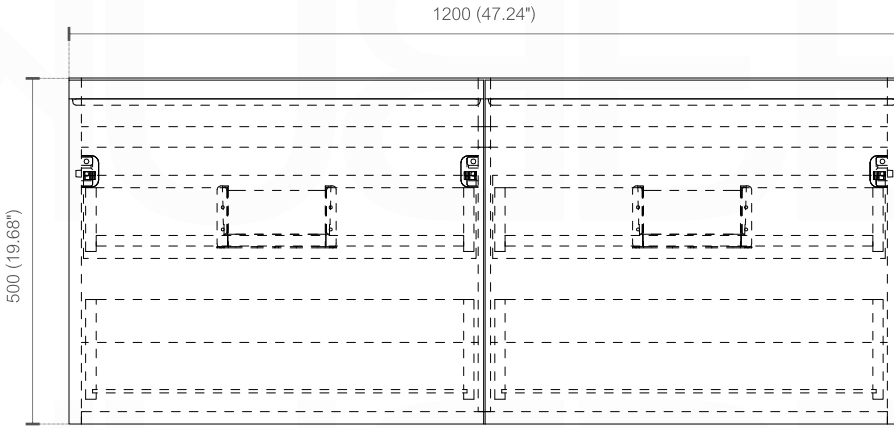

. TOP ELEVATION

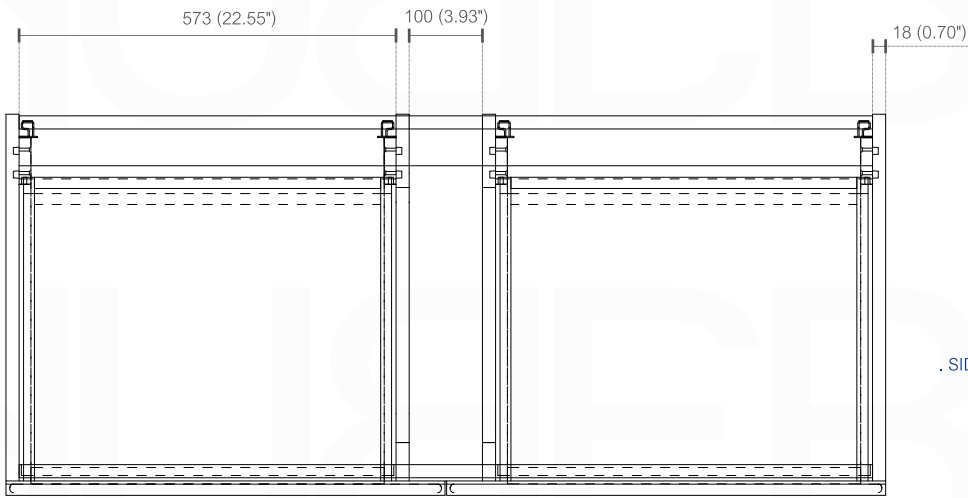

. SIDE ELEVATION

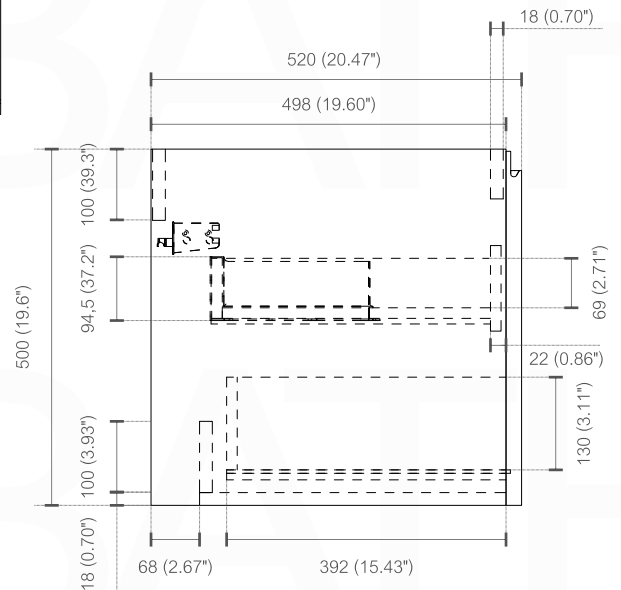

SQUARE SINK SPAIN
48" SINGLE

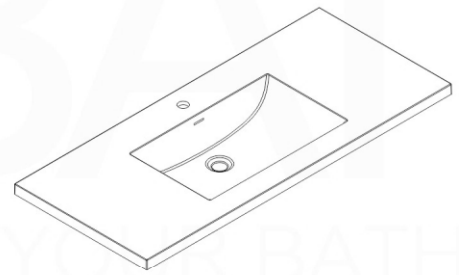

. FRONT ELEVATION

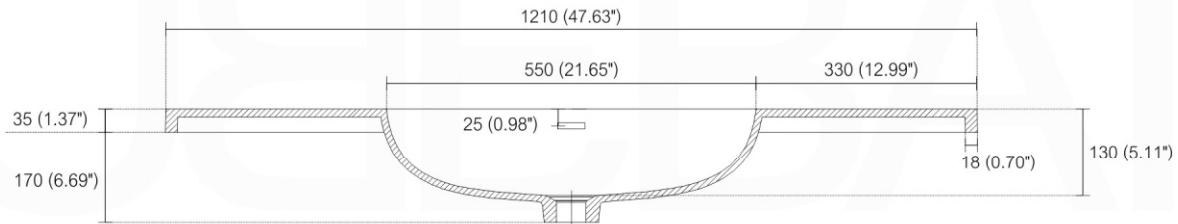

. TOP ELEVATION

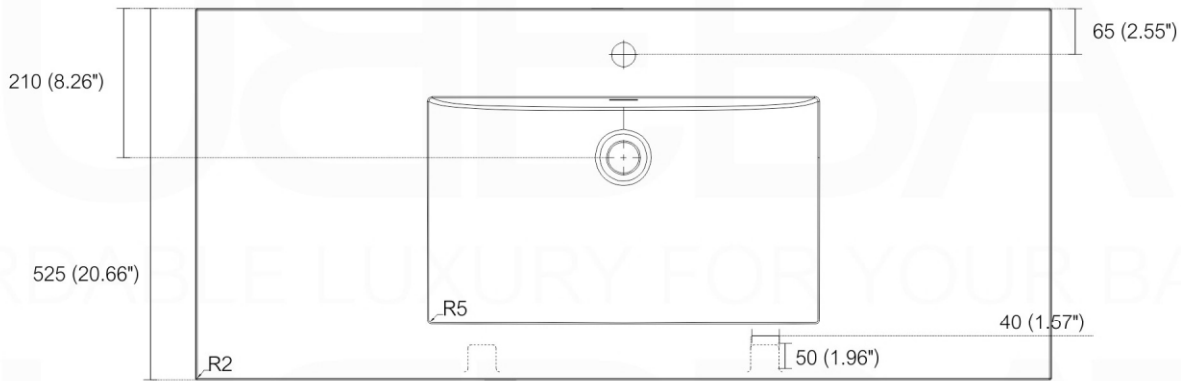

. SIDE ELEVATION

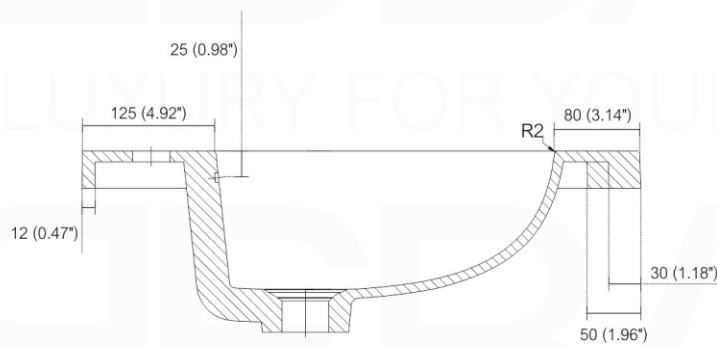

INSTALLATION GUIDE

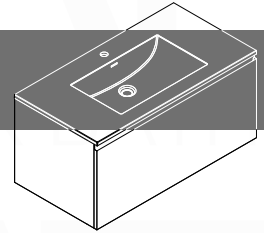

Tools Required for Assembly

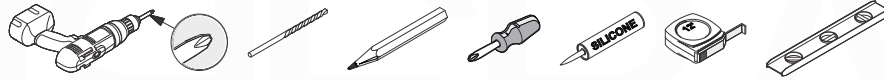

How to Install

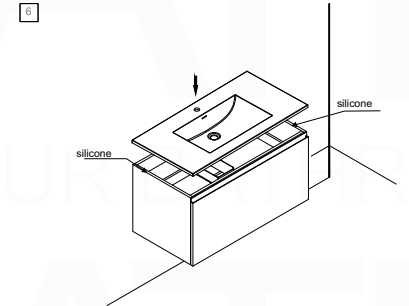
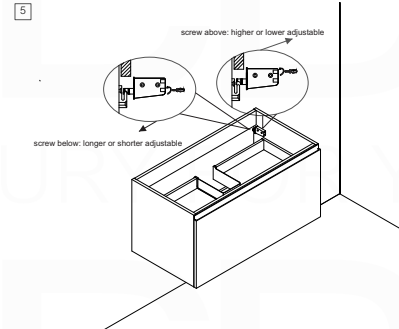
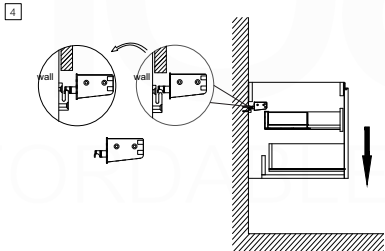
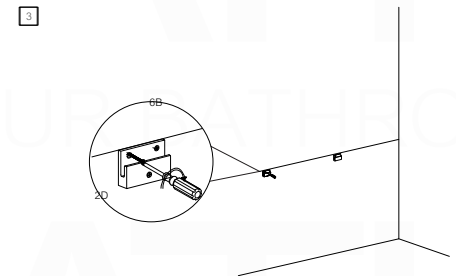
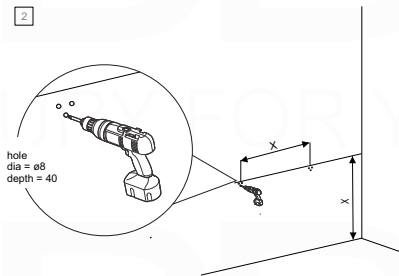
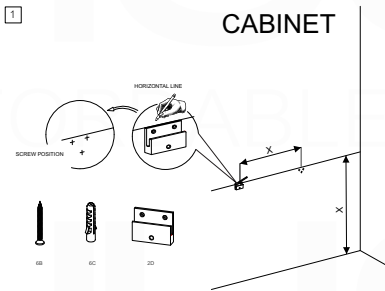

Wall Preparation

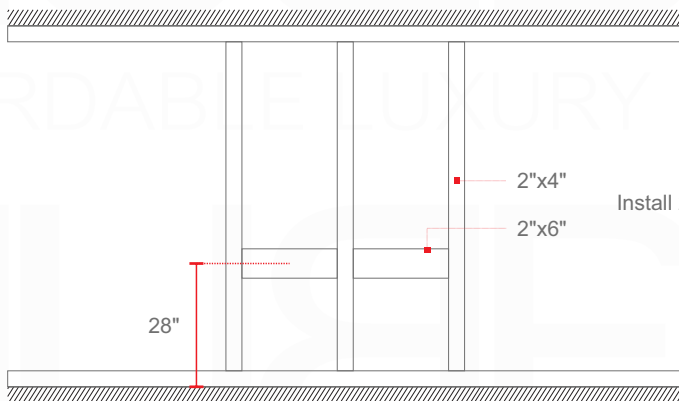

Install 2"x 6" lumber between the wall studs. Desired height: 28".